

PROPOSED HOUSING SCHEME FOR AIR FORCE & NAVAL HOUSING BOARD NEAR MAHAVIR CHOWK AT JALANDHAR

TENDER DRAWING

SALEABLE PARKING = 27NOS.

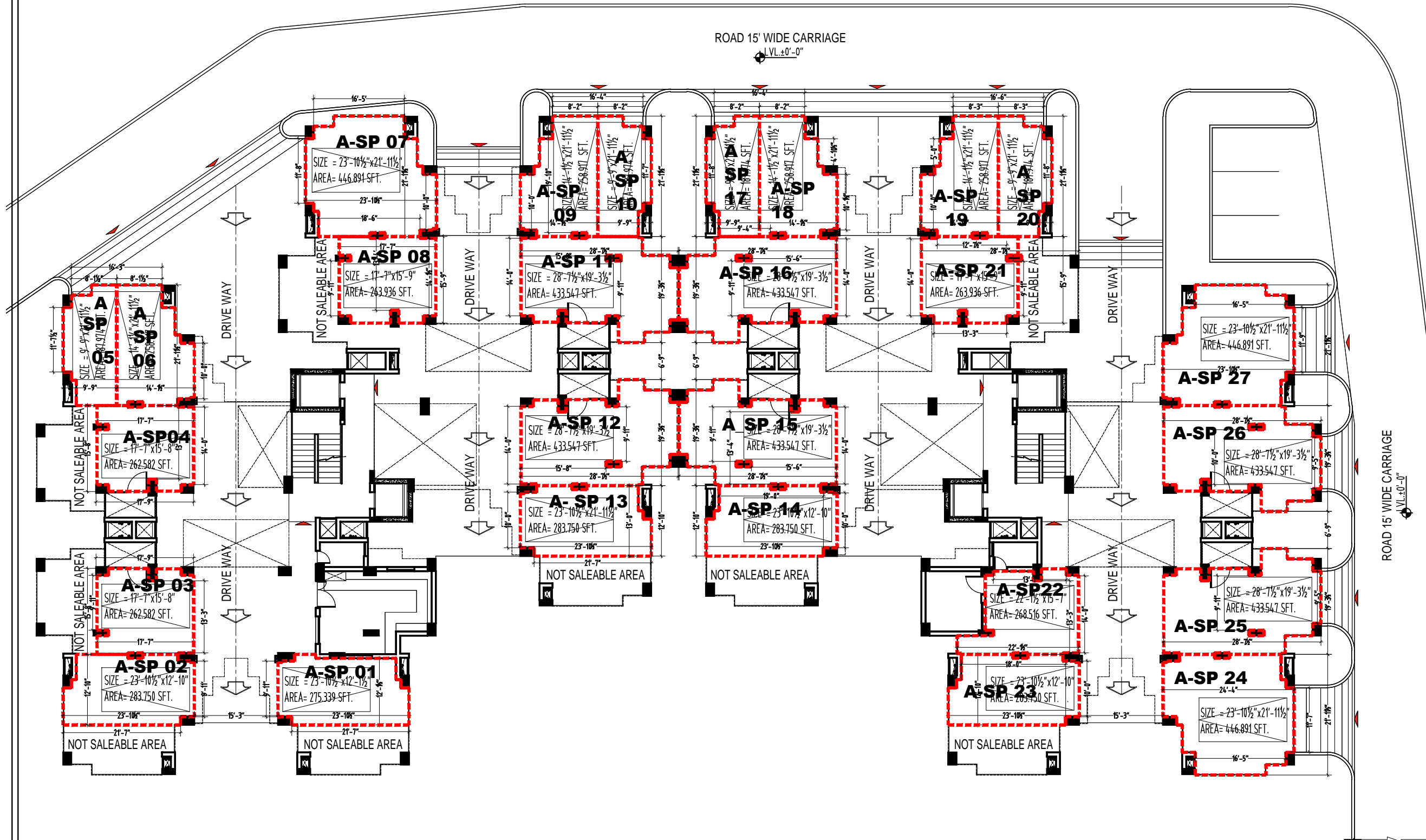

s.no.	date	description	initial

REVISIONS

The data provided on this drawing is copyright material and the property of the architect. It is to be used only for the project for which it is prepared and no part of it is to be reproduced or transmitted in any form or by any means electronic or mechanical, including photocopying, recording, or by any information storage and retrieval system, without the prior written permission of the architect.

- NOTES:
1. CONTRACTOR TO CHECK & VERIFY ALL DIMENSIONS BEFORE EXECUTION OF THE WORK.
  2. FIGURED DIMENSIONS SHALL BE FOLLOWED.
  3. ALL DIMENSIONS ARE GIVEN IN FEET INCHES UNLESS OTHERWISE SPECIFIED.

DRAWINGS APPROVED

AUTHORISED SIGNATORY ...  
 ARCHITECTS AND CONSULTANTS  
**AVINASH KHOSLA AND ASSO.**  
 # 568 - A, POLICE HOUSE LINK ROAD,  
 NEAR FOUNTAIN CHOWK, CIVIL LINES,  
 LUDHIANA - 8. (PB.)  
 PH. 2448401, 2448293 | M. 98140-21780  
 FAX. 0161-2448293 | M. 98140-09514  
 EMAIL. kanavkhosla@consultant.com

AVINASH KHOSLA      KANAV KHOSLA  
 b.arch., i.i.a., m.c.a., f.i.v.      b.arch., masters in U.D. (Ext.) U.K.,  
 i.i.a., m.c.a., f.i.v.

project title:  
 ARCHITECTURE DRAWING  
 ( OFFICER BLOCK TYPE -A )

drawing title:  
 PARKING DETAIL  
 STILTED FLOOR PLAN ( BLOCK - A )

scale:	date:	drg. no.
N.T.S.	01/06/2011	HP/18/AFNHB/10 A/AR/27